

# TIREFOND

## Tête hexagonale

TH

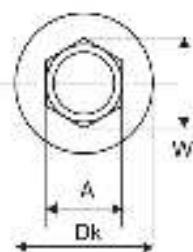
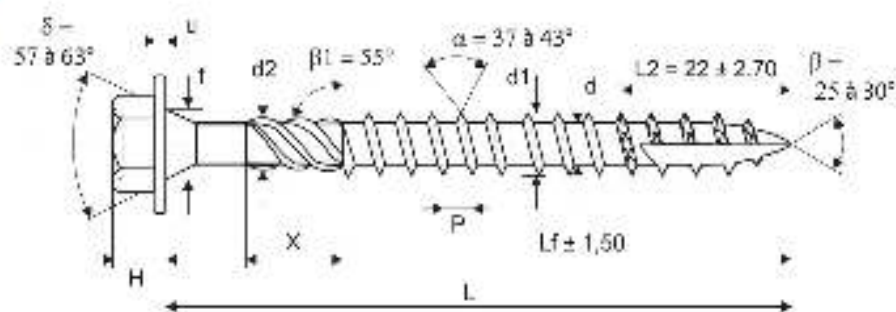
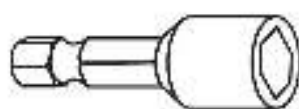

### Caractéristiques

	Ø 6	Ø 8	Ø 10
N° de	N°8	N°10	N°13
Dk	12,50/13,50	16,50/17,50	19,00/20,00
A	7,78/8,00	9,78/10,00	12,78/13,00
W	8,21 mm	10,08 mm	14,26 mm
H	4,50/5,00	6,00/6,50	7,00/7,50
f	8,10/8,50	7,80/8,10	9,50/10,00
u	0,90/1,00	1,00/1,30	1,50/1,80
P	0,80 ± 10%	0,80 ± 10%	0,80 ± 10%
d	3,00/3,60	5,10/5,40	6,20/6,30
d'	5,70/6,00	7,70/8,00	9,85/10,00
X	11,00/13,00	11,00/13,00	11,00/13,00
d2	4,80/5,50	6,80/7,00	8,50/9,30
Double rupture min	11,00 N	25,00 N	44,00 N

Values from  
technical drawings  
supplied  
x 10<sup>-3</sup> mm

Max Ø L = 40/60	50/80	100/120	140/160
Temp. max. C°/1,25	0°/1,30	0°/1,75	0°/1,30



EN 14582+A1  
2012

**ROCKET**★

Acier bichromaté